

# CULLET PREPARATION

## SCRAPER CONVEYORS + CRUSHERS



*Cullet Processing Plants*

*Engineering since 1984*

*Over 1200 machines for glass industry sold to 60+ countries*

## INTRODUCTION

Cullet in the glass industry is defined as either factory or foreign cullet, depending on its origin (internal or external):

- Factory cullet occurs as a waste product in the factory, where it is also remelted
- Foreign cullet refers to glass which is recycled after use, independent of the original producer

After receiving the rejected hot cullet and gobs in the water bath, this scraper conveyor carries the cooled fragmented glass to the stock area

Scraping conveyors are custom-made according to the capacity of glass, the position and number of the chutes. VIDROMECHANICA projects this machine considering a sufficient cooling time and water temperature to obtain a suitable grain size

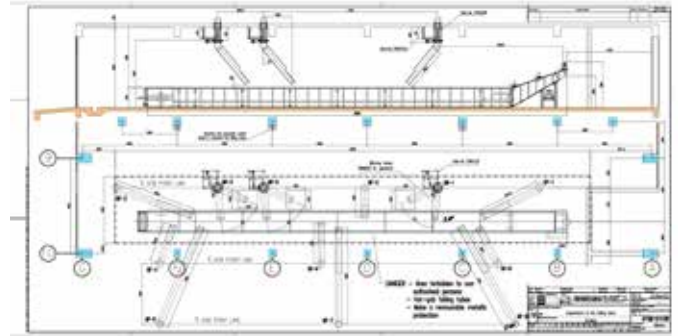

*Save up to 30 %  
of the energy used in the  
melting process*

**This is a simplified online version.  
To receive the complete datasheet,  
please email  
[vidromecanica@vidromecanica.com](mailto:vidromecanica@vidromecanica.com)**

# ENGINEERING, DESIGN, MANUFACTURING AND INSTALLATION



*Innovation and Technology  
since 1984*

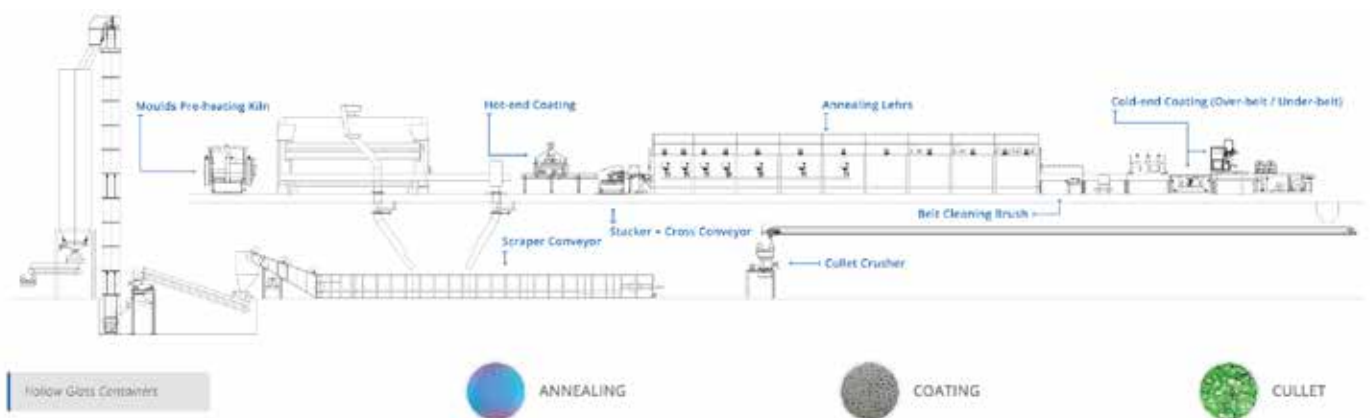

*Our vision is a world inspired by glass,  
empowered by Vidromecanica as a leading  
manufacturer of innovative equipment  
for the glass industry.*

**VIDROMECHANICA, SA**  
www.vidromecanica.com  
vidromecanica@vidromecanica.com  
Rua Central nº 22 – Garcia  
2430-017 Marinha Grande | PORTUGAL  
Tel.: +351 244 555 060

**VIDROMECHANICA**<sup>®</sup>  
GLASS MACHINERY TECHNOLOGY